

# ADAPTOR MODULES

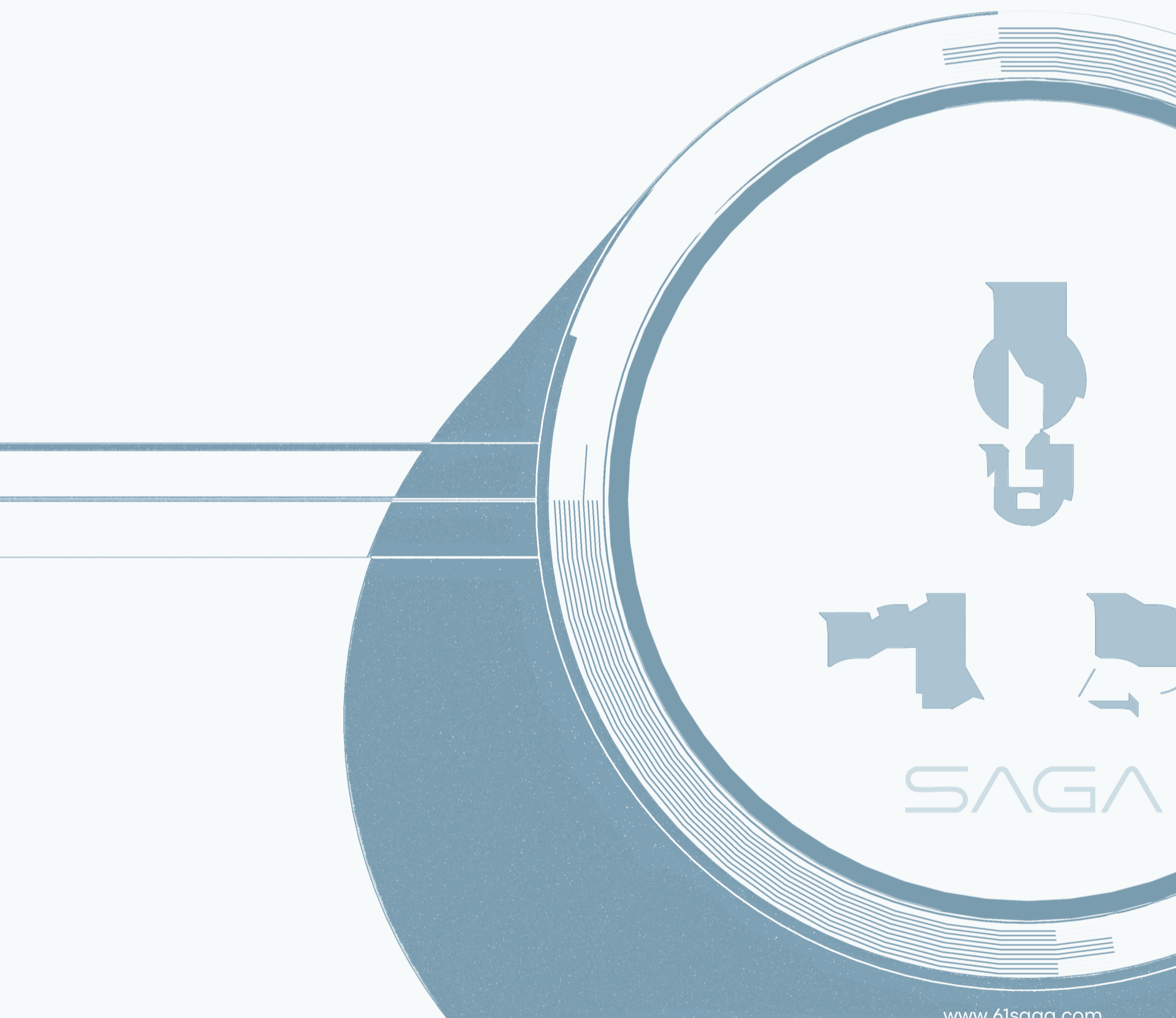

**PRECISION-ENGINEERED MODULAR POWER.**

SAGA Adaptors are the interface between your devices and the power track — available in five configurations to suit every region, use case, and load requirement. Each adaptor snaps effortlessly into any SAGA surface or recess track, rotates 90° clockwise to activate, and lights up with a signature blue LED ring.

- Compatible with all SAGA S Series surface and R Series recess power tracks.
- Plug-and-play snap-in installation; repositionable anywhere along the track length.
- Built-in surge protection, overload auto-reset, and child-proof shutters on all AC models.
- All models comply with IEC 60884-1 and are tested for up to 10,000 insertion cycles.

**01 COMBINED TECHNICAL SPECIFICATIONS — All adaptor models**

MODEL	SOCKET TYPE	WEIGHT	SIZE (L×W×H)	RATED VOLTAGE	RATED CURRENT	RATED POWER	OP. TEMP.
S 49	German / EU (Schuko CEE 7/4)	0.086 kg	71.5×71.5×38.6 mm	250 V AC	15 A	3,750 W	-20°C to +45°C
S 44	UK BS1363 (3-pin British)	0.080 kg	71.5×71.5×29.6 mm	250 V AC	13 A	3,250 W	-20°C to +45°C
S 91	International (Multi-region)	0.080 kg	71.5×71.5×29.6 mm	250 V AC	13 A	3,250 W	-20°C to +45°C
S Ultra	Dual USB-C PD (100 W × 2)	0.080 kg*	71.5×71.5×29.6 mm*	250 V AC	13.25 A*	100 W × 2*	-20°C to +45°C
S One	Compact Combo (AC + USB)	0.070 kg*	71.5×71.5×28.0 mm	250 V AC	10 A (combo)*	2,500 W*	-20°C to +45°C

\* Estimated values for S Ultra and S One; final specifications may vary slightly. S Ultra rated at 5V DC / 3.1A USB-C PD per port. S One combo power is indicative pending final production spec.

**1.1 Common Technical Parameters — All Models**

COMMON PARAMETER	VALUE / SPECIFICATION
Socket Face Diameter	71.5 mm (all models)
Track Compatibility	SAGA S Series Surface   SAGA R Series Recessed   Compatible SAGA tracks
Mounting Method	Snap-in bayonet — align UP arrow, push, rotate 90° clockwise to engage
Activation Indicator	Blue LED ring illuminates when power is active
Deactivation	Remove plug first; rotate 90° counter-clockwise to disengage
Child Safety	Child-proof shutters (all AC socket models)
Surge Protection	Built-in surge & overload auto-reset (all models)
Contact Material	Phosphor bronze, tin/nickel plated
Enclosure Material	PC+ABS blended thermoplastic, aluminium ring bezel
Surface Finish	Brushed anodized aluminium outer ring — Space Grey / Silver
Insertion Cycle Rating	≥10,000 insertions tested
Compliance Standard	IEC 60884-1; CE; RoHS 2011/65/EU
Frequency	50 Hz / 60 Hz
Track Rated Load (max)	S 500: 4,000 W   S 1000: 6,400 W   S 1500: 8,000 W
Operating Humidity	≤90% RH, non-condensing
Storage Temperature	-30°C to +70°C (uninstalled, original packaging)

## 02 INDIVIDUAL ADAPTOR PROFILES



- 15 A / 3,750 W high-power German Schuko socket.
- Universal barrel-pin format for EU/GCC/-global offices.
- Deep 38.6 mm body; largest in the SAGA adaptor family.
- Ideal for high-load appliances, studios, hospitality.
- 13 A / 3,250 W UK BS1363 3-pin socket.
- Slim 29.6 mm profile for clean desk and wall aesthetics.
- Child-proof shutters on all three pins as standard.
- Perfect for UK-spec projects, hotels, co-working.
- 13 A / 3,250 W international multi-region socket.
- Accepts Type A/B/C/I plugs — global traveler friendly.
- Same compact 29.6 mm depth as S 44.
- Ideal for co-working, hospitality, and mixed-use spaces.
- Dual 100 W USB-C Power Delivery (100 W × 2).
- Charges laptops, tablets, phones — no bricks on the desk.
- 5 V DC / 3.1 A per port; 18 W combined output.
- Eliminates clutter; pairs perfectly with any SAGA track.
- 10 A combo socket, ~2,500 W, 28.0 mm ultra-slim depth.
- Slimmest adaptor in the S Series family.
- AC + USB combo in one clean circular module.
- Perfect for low power devices and minimalist setups.

## 03 DIMENSIONAL REFERENCE & INSTALLATION

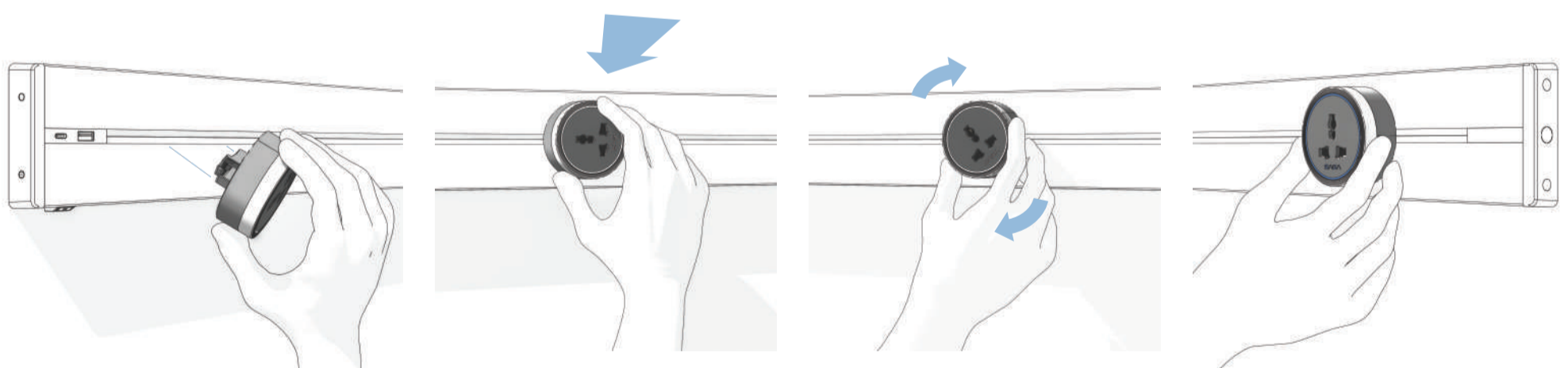

Align buckle with track slot



Push adaptor down firmly



Rotate 90° clockwise



LED ring lights up — ON

INSTALLATION PROCEDURE — ALL SAGA ADAPTOR MODELS

1

2

3

4

5

6

A

A

B

B

C

C

D

D

E

E

F

F

G

G

H

H

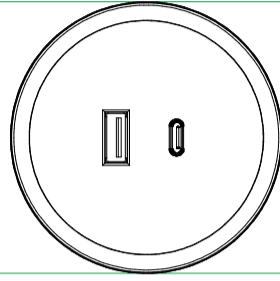
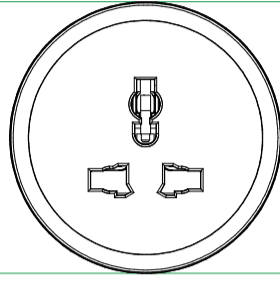
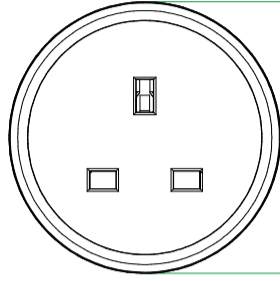

71.5

29.6

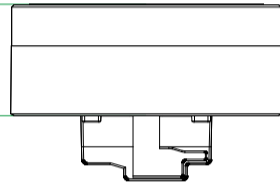
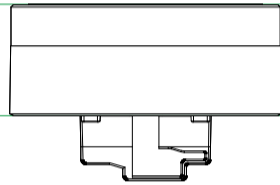
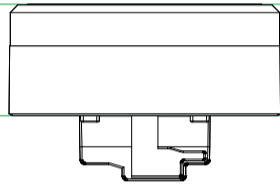

**S44**

**S91**

**S Ultra**

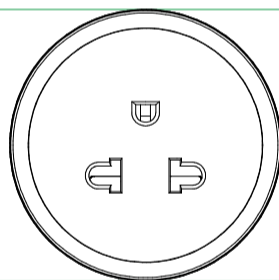
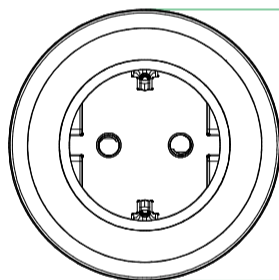

71.5

38.6

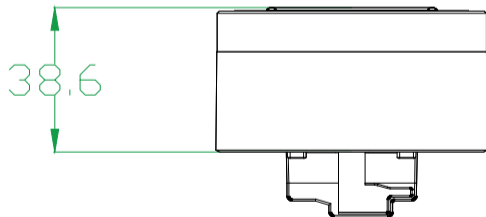

28

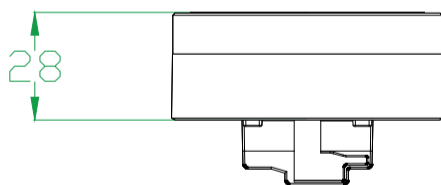

**S49**

**S One**



THE 61

All dimensions are in millimetres. Do not scale drawing.

Title <b>Adaptor Modules</b>	Created by <b>S. GOUD</b>
---------------------------------	------------------------------

Document type <b>Technical Drawing</b>	DWG No. <b>ADP-SERIES-001</b>
---	----------------------------------

Document status <b>For Approval</b>	Scale <b>1:2</b>	Units <b>mm</b>	Revision <b>A</b>	Size <b>A3</b>
--	---------------------	--------------------	----------------------	-------------------

**A3**

1

2

3

4

5

6

### 3.1 Depth Reference by Model

MODEL	DEPTH & NOTES
S 49 (German / EU)	Depth: 38.6 mm   Deepest in family — accommodates German Schuko socket
S 44 (UK BS1363)	Depth: 29.6 mm   Slim profile for clean desk aesthetics
S 91 (International)	Depth: 29.6 mm   Same slim depth as S 44
S Ultra (Dual USB-C PD)	Depth: 29.6 mm*   USB-C Power Delivery electronics internals
S One (Compact Combo)	Depth: 28.0 mm   Slimmest in the family
Face Diameter (all models)	71.5 mm — uniform across the entire S Series adaptor family
Face Size	71.5 mm × 71.5 mm — square footprint fits standard SAGA track slot

Face diameter: 71.5 mm (all models). Depth varies by model.

## 04 INSTALLATION & SAFETY NOTES

### SAFETY WARNINGS - READ BEFORE USE

- Do NOT slide adaptor along the track. Always disengage (rotate counter-clockwise) before repositioning.
- Remove the plug from the adaptor BEFORE rotating to disengage from track.
- For use with SAGA S Series and compatible surface/recess power tracks rated 250 V AC, 32 A only.
- Ensure total load on any track does not exceed rated track power: S 500: 4,000 W | S 1000: 6,400 W | S 1500: 8,000 W.
- Keep away from fire and water. Not for outdoor use. Indoor use only.

### INSTALLATION GUIDANCE

- Insert adaptor with 'UP' arrow aligned to track slot; push down firmly to engage bayonet, then rotate 90° clockwise.
- Blue LED ring illuminates to confirm power is active. If LED does not light, check track is energised.
- All adaptors comply with IEC 60884-1 and are tested for ≥10,000 insertion cycles.
- Installation must comply with local electrical codes and be performed by qualified personnel.
- Do not expose adaptors to harsh chemicals, cleaning solvents, or strong detergents.
- Disengage adaptor from track when not in use for extended periods.

## 05 MATERIALS, COMPLIANCE & ORDERING

PARAMETER	DETAIL
Enclosure	PC+ABS thermoplastic — UL 94 V-0 flame retardant
Outer Ring Bezel	Anodized aluminium alloy — brushed Space Grey finish
Socket / Contacts	Phosphor bronze (tin or nickel plated) — ≥10,000 cycle rated
LED Indicator	Blue LED ring illuminates when power is active
PCB / Surge Protection	Integrated PCB with surge protection and overload auto-reset
RoHS Compliance	Yes — EU RoHS Directive 2011/65/EU (RoHS 2)
REACH Compliance	Yes — no SVHC above 0.1% threshold
Compliance Standards	IEC 60884-1   CE   RoHS   GB/T 1002 (CN)
Available Finishes	Space Grey (standard)   Silver   Custom on request (MOQ)
Ordering / Enquiries	<a href="http://www.61saga.com">www.61saga.com</a>   <a href="mailto:info@61saga.com">info@61saga.com</a>
Phone	+971 54 591 6161 (UAE)   +91 760 000 3900 (India)
Compatibility	SAGA S Series surface tracks (S500, S1000, S1500) + R Series recess tracks (R500, R1000)