

S SERIES

SURFACE POWER TRACK

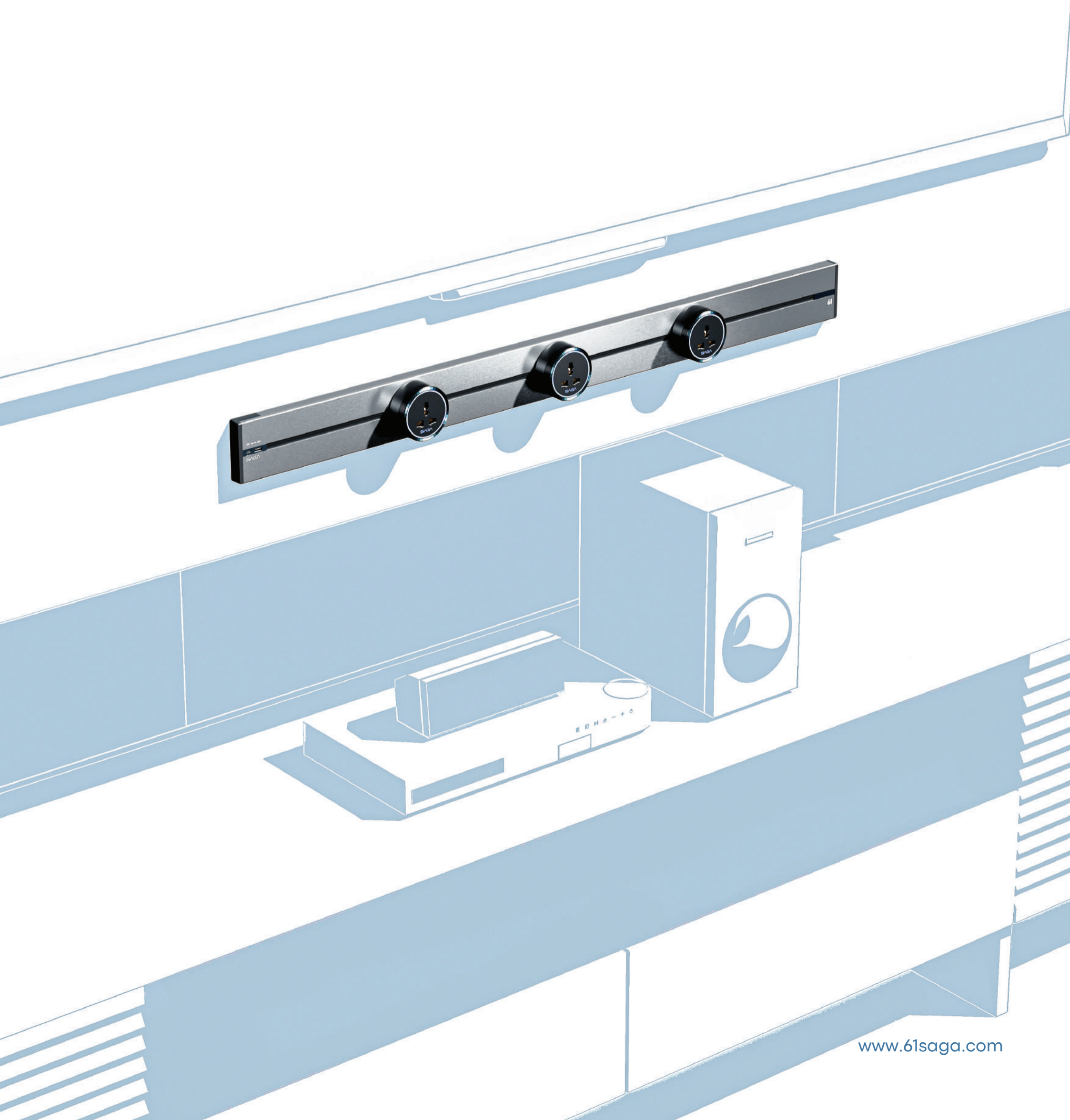

THE S SERIES AT A GLANCE

A **surface mounted** modular power track. Plug-and-play adapters **slide and reposition** anywhere along the rail, and an integrated **motion-activated LED strip** lights the surface the moment any movement is detected.

Document Reference
SAGA-DS-SSERIES-Rev1.0

DWG Reference
S-SERIES-001 (Scale 1:5, A3)

Standards
IEC 60884 | IS 1293 | IS 732
RoHS 2011/65/EU | IP20

Combined Specification Sheet — S500 & S1000



250V	32A	8000W	IP20
Rated Voltage (AC)	Rated Current	Rated Power	Protection Rating

01 MODEL COMPARISON — S Series Surface Track (S500 & S1000)

PARAMETER	S500	S1000
Track Length	500 mm	1000 mm
Adapter capacity	Upto 5	Upto 10
Approximate weight	1.2 kg	2.0 kg
Rated voltage	250 V AC · single phase	250 V AC · single phase
Rated current	32 A	32 A
Rated power capacity	8000 W (8 kW) max continuous	8000 W (8 kW) max continuous
Frequency	50 / 60 Hz	50 / 60 Hz
Track width	86 mm	86 mm
Track material	Anodized aluminium alloy 6063-T5	Anodized aluminium alloy 6063-T5
Installation	Surface-mounted — wall, desk or under-cabinet	Surface-mounted — wall, desk or under-cabinet

PARAMETER	S500	S1000
Adapter system	SAGA quarter-turn twist-lock · up to 16 A / adapter	SAGA quarter-turn twist-lock · up to 16 A / adapter
Protection rating	IP20 · touch-safe (1 mm probe)	IP20 · touch-safe (1 mm probe)
Safety / compliance	IEC 60884 · IS 1293 · IS 732 · RoHS 2011/65/EU	IEC 60884 · IS 1293 · IS 732 · RoHS 2011/65/EU

02 S SERIES OVERVIEW

The **S Series** is SAGA's surface-mounted power track family, engineered to distribute power exactly where it is needed while keeping worktops, walls and joinery clean and uncluttered. The **S500** and **S1000** are the primary SKUs; an **S1500** variant also exists, though this sheet focuses on the S500 and S1000.

Every S Series track is built on the same **Common Core Assembly** — high conductivity copper busbars within fire-retardant insulation inside an anodized aluminium body — shared across SAGA's S Series (Surface) and R Series (Recessed). This guarantees **identical electrical performance** and full cross compatibility of adapters across the SAGA range.

All variants offer **modular adapters**, an integrated **motion-activated LED strip**, and the same electrical rating of **250 V AC / 32 A / 8000 W** — differing only in length, adapter capacity and weight.

SHARED ACROSS THE SERIES

Rated voltage	250 V AC
Rated current	32 A
Rated power	8000 W
Adapter pitch	100 mm
Body material	Aluminium
Protection	IP20
Service life	≥ 15 yrs

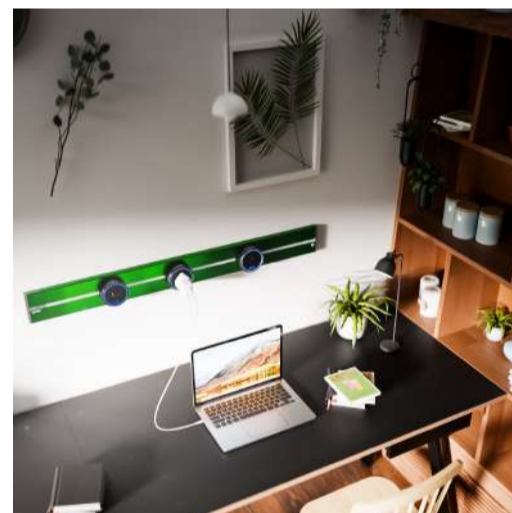

03 FEATURES & BENEFITS

MODULAR POWER DISTRIBUTION

Adapters slide along the track and reposition at any time — no socket shortage at the workstation.

SPACE-SAVING DESIGN

A slim, surface-mounted profile that keeps desks and worktops clean and clutter-free.

SAFE & DURABLE

Touch-safe, Class I earthed aluminium housing with high-quality internal components for everyday use.

HIGH POWER HANDLING

A single 32 A circuit delivers up to 8000 W (8 kW) of continuous capacity across the track.

MOTION-ACTIVATED LIGHTING

An integrated LED strip lights the surface automatically when motion is detected — no hunting for switches.

CROSS-COMPATIBLE ADAPTERS

Type C / G / I, USB-A, USB-C PD, data & more — all SAGA adapters fit every S and R Series track.

3.1 Primary applications

Office workstations

Meeting & conference tables

Kitchen worktops

Under-cabinet

Retail display & shelving

Hospitality counters

Studios & workshops

Co-working spaces

04 PRODUCT IDENTIFICATION

PARAMETER	S500	S1000
Product name	S500 Surface Track	S1000 Surface Track
Model / Part number	S500-500MM	S1000-1000MM
Series	S Series (Surface) — SAGA by 61	S Series (Surface) — SAGA by 61
Generation	2nd Generation Surface Track	2nd Generation Surface Track
Category / Type	Modular surface-mounted electrical power track	Modular surface-mounted electrical power track
Brand / Manufacturer	SAGA by 61	SAGA by 61
Country of origin	China · Designed by 61, Australia	China · Designed by 61, Australia
Intended markets	India · GCC · SE Asia · Australia · Global	India · GCC · SE Asia · Australia · Global
Website	61saga.com	61saga.com

05 ELECTRICAL SPECIFICATIONS — Identical across S500 & S1000

ELECTRICAL PARAMETER	VALUE / REQUIREMENT
Rated voltage	250 V AC (single phase)
Frequency	50 Hz / 60 Hz
Rated current	32 A
Rated power capacity	8000 W (8 kW) maximum continuous load
Operating voltage range	110 V~ / 220–250 V~ (adapter-dependent)
Short-circuit current (limit)	MAX 32 A
Breaking capacity	MAX 32 A
Overcurrent protection	Not built-in — upstream MCB / RCCB required
Power factor	Unity (resistive reference); depends on load
Earthing	Mandatory — body bonded to protective earth (PE)
Insulation class	Class I (requires earth connection)
Dielectric strength	≥ 2000 V AC for 1 min (live to earth)
Insulation resistance	≥ 5 MΩ (500 V DC megger test)
Leakage current	< 0.5 mA
Integrated LED strip	Low-voltage driver, motion-triggered (S Series)

06 MECHANICAL & PHYSICAL SPECIFICATIONS

MECHANICAL PARAMETER	S500	S1000
Overall track length	500 mm	1000 mm
Product weight (body only)	1.2 kg	2.0 kg
Adapter capacity	Up to 5	Up to 10
Track width	86 mm	86 mm
Profile height (above surface)	19 mm	19 mm
Body profile	Extruded aluminium — uniform rectangular cross-section	Extruded aluminium — uniform rectangular cross-section
Body material	Anodized aluminium alloy 6063-T5 (or equivalent)	Anodized aluminium alloy 6063-T5 (or equivalent)
Surface finish	Hard-anodized — Silver / Space Grey / Matte Black / custom RAL	Hard-anodized — Silver / Space Grey / Matte Black / custom RAL
End caps	Snap-fit polymer — UL 94 V-0	Snap-fit polymer — UL 94 V-0
Busbar material	High-conductivity electrolytic copper, tin-plated contacts	High-conductivity electrolytic copper, tin-plated contacts
Busbar insulation	Fire-retardant rubber / XLPE — continuous along length	Fire-retardant rubber / XLPE — continuous along length
Integrated lighting	Motion-activated LED strip along track length	Motion-activated LED strip along track length
Probe test	1 mm probe test passed — no live parts accessible without adapter	1 mm probe test passed — no live parts accessible without adapter

07 DIMENSIONAL DRAWINGS — All dimensions in mm

WIRING PARAMETER	SPECIFICATION
Conductor Material	Electrolytic copper only — aluminium conductors strictly prohibited
Cable Type	PVC / XLPE insulated, FRLS (Flame Retardant Low Smoke) — IS 694 / IS 1554
SAGA Factory Wire Gauge	6 mm ² (pre-wired supply tail within track body)

1

2

3

4

5

6

A

A

B

B

C

C

D

D

E

E

F

F

G

G

H

H

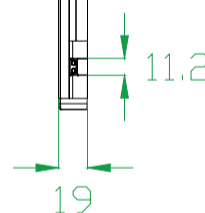
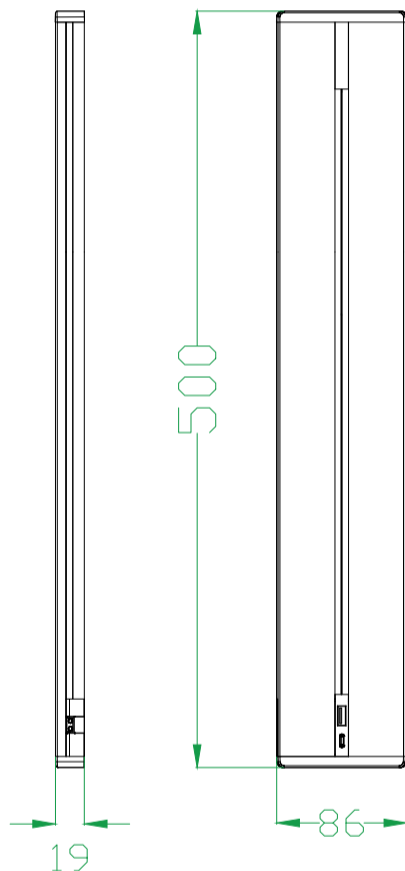
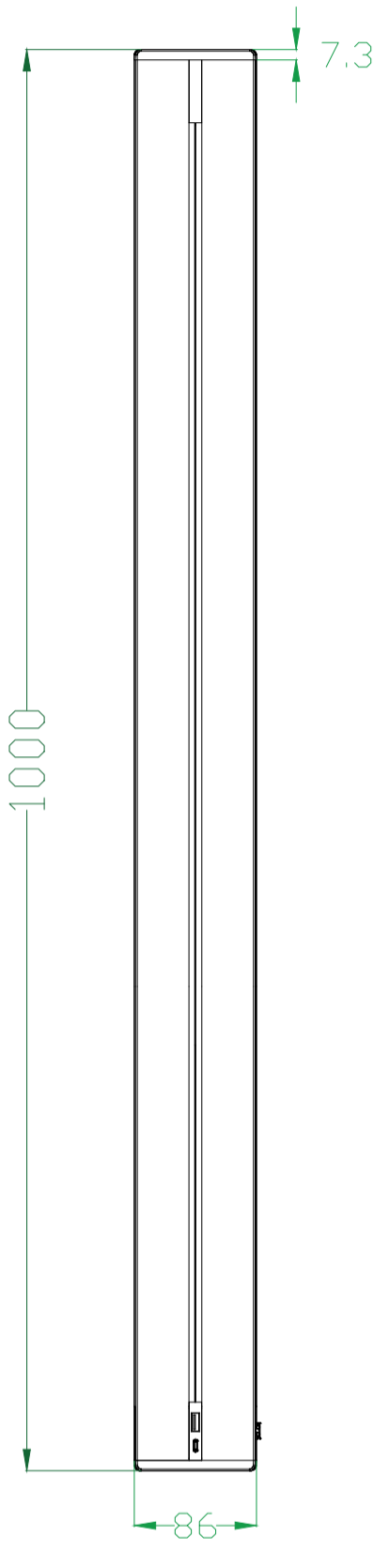
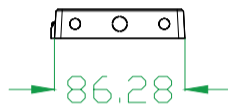
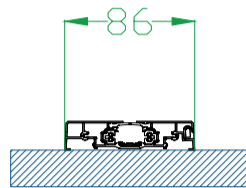

S500

S1000

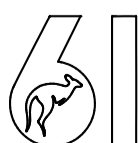

THE 61

All dimensions are in millimetres. Do not scale drawing.

Title	Created by
S-series Surface Power Track	S. GOUD

Size

Document type	DWG No.
Technical Drawing	S-SERIES-001

A3

Document status	Scale	Units	Revision
For Approval	1:5	mm	A

1

2

3

4

5

6

08 SURFACE MOUNTING & FIXING

The S Series mounts **on top** of the surface — no routing or cutout is required. The track is fixed through its base with screws and end-brackets, making it suitable for retrofit onto existing furniture and walls.

MOUNTING PARAMETER	SPECIFICATION / REQUIREMENT
Mounting method	Surface-mounted — fixed through base with M4 / M5 screws + end brackets
Recommended surfaces	Solid wall, timber / MDF / plywood, desk, worktop, under-shelf, joinery face
Fixing points	Minimum 3 — both ends + 1 centre; intermediate fixing every ≤ 500 mm
Surface preparation	Flat, clean, load-bearing; pre-drill pilot holes per fixing template
Adhesive option	Foam tape for light-duty only — not a substitute for mechanical fixings
Cable entry	Rear or end entry with strain-relief gland / bushing mandatory
Orientation	Horizontal or vertical; adapters must remain accessible
Thermal clearance	Maintain ≥ 10 mm clear air gap around the track for dissipation
Fastener torque	Per fastener spec; do not over-tighten the aluminium body

09 WIRING & CABLE REQUIREMENTS — For licensed electricians

CABLE SIZE	MAX LOAD POWER	MAX CURRENT	USAGE GUIDANCE
1.5 mm ² copper	4,000 W	16 A	Short bench / 2-adapter lightly-loaded circuits only
2.5 mm ² copper	6,250 W	25 A	Standard office workstation, up to 6 adapters
4.0 mm ² copper	8,000 W	32 A	Full track at rated capacity — recommended minimum
6.0 mm ² copper	8,000 W	32 A	Factory default supply-tail gauge specified by SAGA

WIRING PARAMETER	SPECIFICATION
Conductor Material	Electrolytic copper — no aluminium permitted
Cable Type	PVC / XLPE insulated, FRLS — IS 694 / IS 1554
Colour Coding	Phase: Red/Brown · Neutral: Black/Blue · Earth: Green-Yellow
Bending radius	Min. 6× cable OD (PVC); 8× (XLPE)
Max voltage drop	$\leq 3\%$ at full load (IS 732 / IEC 60364-5-52)
Terminal torque	3–4 Nm (6 mm ² terminals) — calibrated screwdriver
Earth continuity	Verify $< 0.1 \Omega$ between track body and MDB earth bar

10 CONSTRUCTION, MATERIALS & ARCHITECTURE

The S Series is built around the SAGA Common Core Assembly — the same copper busbars, insulated housing and contact system shared across the S Series (Surface) and R Series (Recessed) tracks — guaranteeing identical electrical performance and full cross-compatibility of adapters.

COMPONENT	MATERIAL / SPECIFICATION
Track Body	Extruded aluminium alloy 6063-T5 — anodized for corrosion resistance
Busbars	High-conductivity electrolytic copper (≥ 99.9%), tin-plated contacts
Busbar housing (inner)	Flame-retardant rubber / XLPE insulation — continuous
End Caps	UL 94 V-0 flame-retardant thermoplastic — snap-fit
Adapter Socket Body	PC+ABS blended thermoplastic — UL 94 V-0 rated
Contact Springs	Phosphor bronze (tin/nickel plated) — rated ≥ 10,000 insertion cycles
Mounting Hardware	Stainless steel M4/M5 fasteners — corrosion resistant
Core assembly	Common Core — shared across S Series & R Series
RoHS compliance	Yes — EU RoHS Directive 2011/65/EU (RoHS 2)
REACH compliance	Yes — no SVHC above 0.1% threshold
Halogen content	Halogen-free (LSZH) insulation available on request

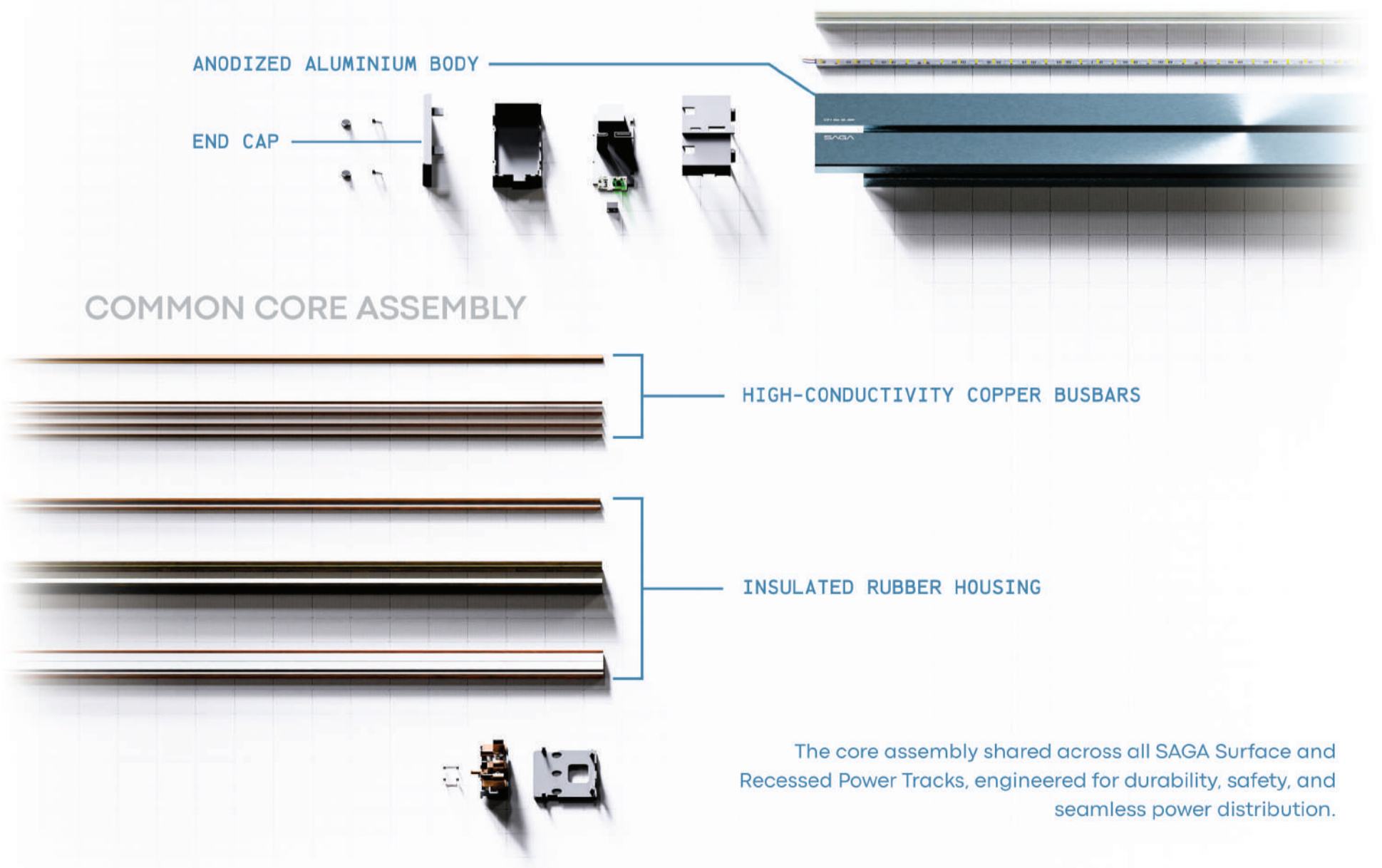

11 ENVIRONMENTAL & OPERATING CONDITIONS

ENVIRONMENTAL PARAMETER	VALUE / REQUIREMENT
Operating temperature	-20 °C to +45 °C (nominal indoor use)
Storage temperature	-30 °C to +70 °C (uninstalled, original packaging)
Operating humidity	≤ 90% RH, non-condensing
Altitude	Up to 2000 m (derate 1% per 100 m above)
IP rating	IP20 — protected against solids > 12 mm; no liquid rating
Indoor / outdoor use	Indoor use only — not rated for wet areas
Pollution degree	Pollution Degree 2 (normal office environment)
Overvoltage category	Category II (IEC 60664-1) — fixed installations
Ventilation	Maintain ≥ 10 mm clear air gap for thermal dissipation
Expected service life	≥ 15 years; 10,000+ adapter insertions

12 SAFETY FEATURES & PROTECTION

SAFETY FEATURE	DESCRIPTION
Touch-Safe Design	1 mm probe test passed — live busbars inaccessible without adapter; IP20 finger-safe
Grounding / earthing	Aluminium body bonded to PE; adapters earth-bonded via track contact
Fire-retardant housing	Insulator housing & end caps UL 94 V-0; aluminium body = passive heat sink
No exposed live parts	Copper busbars fully enclosed in insulated rubber housing
Short-circuit withstand	MAX 32 A — upstream 10 kA MCB provides fault clearance
Adapter lock mechanism	Quarter-turn positive lock — cannot detach under load
Child safety	1 mm probe-test compliance prevents accidental contact
Overload protection	Upstream 32 A Type B/C MCB mandatory — not built into track
RCD / RCCB protection	30 mA RCCB mandatory upstream for personal protection
Surge protection	Type 2 SPD at the distribution board strongly recommended

13 ADAPTERS

PARAMETER	S500	S1000
Adapter System	Proprietary SAGA twist-lock — quarter-turn engagement	Proprietary SAGA twist-lock — quarter-turn engagement
Adapter Positions	Up to 5 positions (100mm centres)	Up to 10 positions (100mm centres)
Rated Current / Adapter	Up to 16 A (32 A aggregate)	Up to 16 A (32 A aggregate)
Available Sockets	Type C/G/I/D/M, Universal, USB-A, USB-C PD, HDMI, CAT6, Wireless Charging, Blank	Type C/G/I/D/M, Universal, USB-A, USB-C PD, HDMI, CAT6, Wireless Charging, Blank
Hot-Swap	De-energise recommended; safe by design	De-energise recommended; safe by design
Cross-Compatibility	All SAGA adapters compatible (same Core Assembly as S & R Series)	All SAGA adapters compatible (same Core Assembly as S & R Series)
Custom / OEM Adapters	Available on request	Available on request

14 INSTALLATION STEPS

Step 1 — Mark	Mark fixing centres + cable entry on the surface
Step 2 — Position	Offer up the track; check it sits flat and level
Step 3 — Cable	Route supply (4 mm ² min, FRLS); fit strain-relief gland
Step 4 — Connect	L / N / PE per colour code; torque 3–4 Nm
Step 5 — Fix	M4 / M5 screws: both ends + centre minimum
Step 6 — Test	Earth continuity < 0.1 Ω; IR > 5 MΩ; power on
Step 7 — Clarify	Licensed electrician signs off before energising

15 STANDARDS, CERTIFICATIONS & TESTING

STANDARD / DIRECTIVE	SCOPE
IEC 60884-1	Plugs & socket-outlets
IEC 60439-1	LV assemblies (busbar)
IEC 60664-1	Insulation — PD2, OVC II
IEC 60529	IP code — IP20
IS 1293:2019	Plugs & sockets (BIS)
IS 732:2019	Electrical wiring code
IS 3043:2018	Earthing code of practice
RoHS / REACH	Hazardous substances

TEST PARAMETER	PASS CRITERION
Dielectric strength	2000 V AC / 1 min
Insulation resistance	≥ 5 MΩ @ 500 V DC
Earth continuity	< 0.1 Ω to PE
1 mm probe test	No live-part contact
Current capacity	32 A · ≤ 45 K rise
Flammability	UL 94 V-0 (polymers)
Contact resistance	< 10 mΩ at rated current
Insertion / withdrawal	≥ 10,000 cycles

16 ORDERING, CUSTOMISATION & MAINTENANCE

Standard lengths	500 · 1000 · 1500 mm · custom
Standard finishes	Silver Anodized · Space Grey · Matte Black
Custom options	Custom RAL · brushed · sandblasted (MOQ)
OEM / white-label	Available on agreement
Documentation	Product sheet · install guide · RoHS · REACH
Spare parts	End caps · screws · adapter modules
Routine cleaning	Dry / damp cloth; no solvents in the slot
Adapter contacts	Inspect annually; replace if > 10 mΩ
Busbar inspection	2-year interval for insulation cracking
Annual tests	Earth continuity + IR (commercial)
Fault — MCB trips	Overload — reduce load ≤ 8000 W / 32 A
Warranty	Contact SAGA at 61saga.com

17 LEGAL NOTICES & TENDER REFERENCE

Qualified personnel only. Installation, maintenance and testing must be performed exclusively by licensed / registered electrical contractors. Unauthorised installation voids warranty and may constitute a statutory offence.

No liability for misuse. SAGA by 61 accepts no liability for damage, injury or loss arising from improper installation, overloading, use of non-SAGA adapters, or failure to follow these specifications. **Specifications are subject to change without prior notice.**

GOVERNMENT TENDER REFERENCE CLAUSE — COPY / PASTE SPECIFICATION

"Supply & installation of Modular Surface-Mounted Power Track — S500 (500 mm) or S1000 (1000 mm) as specified. Anodized aluminium alloy body with high-conductivity copper busbars and fire-retardant insulation; rated 250 V AC single phase / 32 A / 8000 W; IP20; Class I earthed; operating temperature -20 °C to +45 °C; UL 94 V-0 polymer components; 1 mm probe-test compliant; integrated motion-activated LED strip; modular adapter system. Compliant with IEC 60884 · IS 1293:2019 · IS 732:2019 · IS 3043:2018 · RoHS 2011/65/EU; complete with upstream 32 A Type-B MCB + 30 mA RCCB. Brand: SAGA by 61 (Model S500 / S1000) or approved technical equal."